

Composite dry sliding bushings, metric dimensions

Principal dimensions			Basic load ratings		Mass	Designation
d	D	B	dynamic C	static C0		
mm			kN		kg	-
<b>8</b>	10	10	9,65	20	0,0016	PCM 081010 M

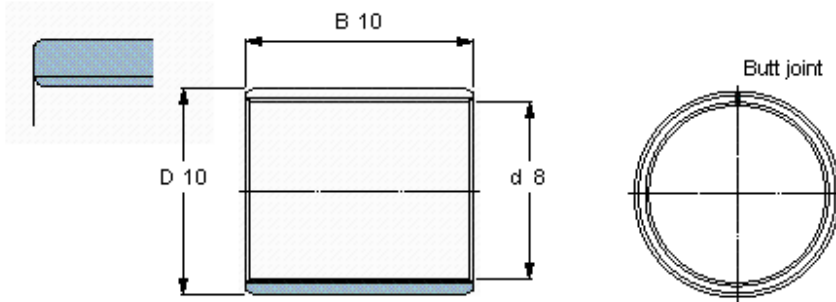

**Specific load factor**  
**Material constant**

K 120  
K<sub>M</sub> 1900